

REPLACEMENT COMPONENTS (CONSUMABLES)

Component	WLCP Part No.	Frequency of Replacement
UV Light, 4 Watts Assembly Counter Top	K-AK-CT-2030-L00-C3	Every 12 months, or as required
UV Light, 8 Watts Assembly Tower	K-AK-CT-2001-L00-GF	Every 12 months, or as required
Hot Tank 1.5 Liter (.40 Gallons) 87°C (189°F) - Counter Top	HT-3024	Replace every 3-5 years depending on usage
Hot Tank 1.5 Liter (.40 Gallons) 87°C (189°F) - Tower	HT-3024	Replace every 3-5 years depending on usage
GAC Filter - 10" Carbon Activated Inline Filter – <i>Optional</i> <i>*Filter Element PN FT-0038-WLT</i>	FT-0035	Every 6-months or as required. Local water conditions will determine proper filter type and maintenance schedule. FT-0035-IL-WLT
Carbon Block - 10" CBC 1 Micron Lead and Cyst Reduction Inline Filter – <i>Optional</i> <i>*Filter Element PN FT-0064-WLT</i>	FT-0063	Every 6-months or as required. Local water conditions will determine proper filter type and maintenance schedule. FT-0063-IL-WLT
Sediment Filter - 10" Sediment 20 Micron Inline Filter – <i>Optional</i> <i>*Filter Element PN FT-0055-WLT</i>	FT-0053	Every 6-months or as required. Local water conditions will determine proper filter type and maintenance schedule. FT-0053-IL-WLT

⚠ CAUTION! Use only Waterlogic Replacement parts that can be obtained from *Waterlogic* or an *Authorized Waterlogic Dealer*, failure to do so will void the Warranty.

See Installation and Service Manual for additional information.

Hot Tank Service

Hot Tanks (with controls) must be replaced at least every 3-5 years depending on usage. Descaling hot tank may be required on a regular basis depending upon filtration and local water conditions. See Installation and Service Manual for further details.

Surface Cleaning

Clean on a regular basis with damp lint free cloth. Never use harsh chemicals (alcohol or acid based) or abrasive agents on any part of the product to avoid damage. A mild cleaner such as Simple Green or equivalent is recommended.

DISPOSAL

End of Life

At the **end of this product's life**, ensure that it is disposed of in an environmentally friendly manner which is fully compliant **with all Federal/State/Local Requirements and Guidelines**. Do not dispose of this appliance with normal household or business waste.

WL3 IT TOWER DRAWING AND PARTS LIST

Wetted Drawing

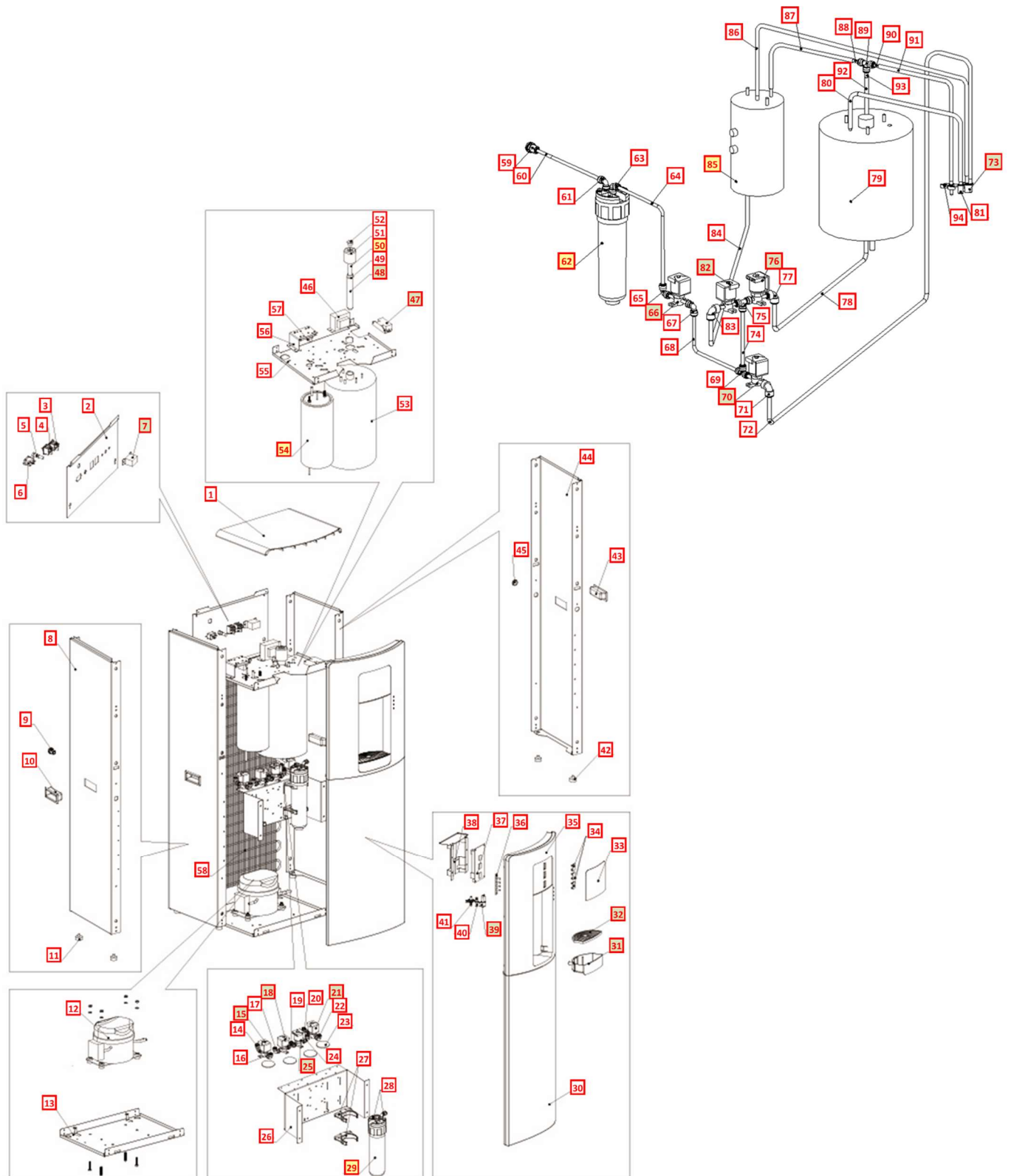

No	WLCP Part No.	Part No.	Description	
1	PL-1381	PL-1381	WL3 Top Cover Black	
2	12-1622	ST-8028	650 FS back Panel Black	
3	10-3009	EL-5005	Switch - Heater/Compressor (Green)	
4	12-5600	EL-5019-A	Power Switch (Red)-No back lights	
5	10-3014	EL-5053	Fuse Holder & Fuse 110V/15A with only one wire chiller3 & lo	
6	EL-0061-L00-00	EL-0061-L00-00	Socket for Plug Connection V0 class	
7	12-1101	CT-2016	Cold Tank Thermostat	
8	10-4002	ST-8225	WL950,650,750 Universal Left&Right Side panel Black	

9	PU-4028	PU-4028	JG Bulkhead Union 1/4"x1/4"	
10	10-4004	PL-1120	Plastic Handle Black	
11	10-3083	ST-8016	Unit Control Rubber Feet WL3000	
12	CO-0020-L00-00	CO-0020-L00-00	LG Compressor 120V R134A-CSB035LJCM	
13	12-1602	ST-8035	Down Base White - WL650 universal as ST-8011	
14	PU-4008	PU-4008	JG Equal Elbow 1/4"	
15	PU-0017-100-00	PU-0017-100-00	MS DC Solenoid Valve SWV24-01	
16	PU-4008	PU-4008	JG Equal Elbow 1/4"	

17	PU-4007	PU-4007	JG Reducing Elbow 5/16"x1/4"	
18	PU-0017-100-00	PU-0017-100-00	MS DC Solenoid Valve SWV24-01	
19	PU-4011	PU-4011	JG Equal Tee 1/4"	
20	PU-4011	PU-4011	JG Equal Tee 1/4"	
21	PU-0017-100-00	PU-0017-100-00	MS DC Solenoid Valve SWV24-01	
22	PU-4008	PU-4008	JG Equal Elbow 1/4"	
23	CU-0001	CU-0001	Cushion for solenoid valve	
24	PU-4007	PU-4007	JG Reducing Elbow 5/16"x1/4"	

25	PU-0017-100-00	PU-0017-100-00	MS DC Solenoid Valve SWV24-01	
26	19-1016	ST-8206CN	Universal FS Filter Bracket for 950,650,850	
27	20-1010	PU-4161	2.8" Filter Clip	
28	PU-4008	PU-4008	JG Equal Elbow 1/4"	
29	FT-0053 FT-0035 FT-0063	FT-0053 FT-0035 FT-0063	WL Inline Filter	
30	PL-0020-L00-BL	PL-0020-L00-BL	WL3 front down panel Black-No logo printing	
31	N/A	PL-0049-L00-BL-WLG	WL3 lower drip tray body for WLG black - WL logo - w.BioCote	
32	PL-0029-L00-BL	PL-0029-L00-BL	WL3 Drip tray grill - Black-Biocote added.	

33	N/A	LP-0535-L00-00	WL3 HCA Countertop UI Label	
34	N/A	PL-1379	WL3 Front Upper Button Cover	
35	N/A	PL-0291-L00-BL	WL3 Front upper panel Black	
36	EN-6139	EN-6139	WL3 LED PCB	
37	N/A	EN-0135-L00-00	WL3 NEW HCA UI PCB	
38	N/A	ST-0331-L00-00	WL3 HCA UI PCB Cover	
39	PL-1382	PL-1382	WL3 Hot Water Faucet	
40	N/A	ST-0330-L00-00	WL3 Countertop HCA UT model - Cold Water Faucet	

41	N/A	ST-0327-L00-00	WL3 Cold Faucet Fixing Bracket for HCA UT	
42	10-3083	ST-8016	Unit Control Rubber Feet WL3000	
43	10-4004	PL-1120	Plastic Handle Black	
44	10-4002	ST-8225	WL950,650,750 Universal Left&Right Side panel Black	
45	N/A	PL-1293	Rubber O-ring for GF Side Panel Drain Hole	
46	EL-0016-L00-00	EL-0016-L00-00	Power Transformer 120V/2A	
47	EN-0111-L00-00	EN-0111-L00-00	8w/4w Electronic Ballast 120V 60Hz	
48	10-1400	CT-2002	Quartz Sleeve D310mm for 8W Lamp	

49	10-2500	CT-2006	O-ring (Black Quartz Sleeve)	
50	K-AK-CT-2001-L00-GF	K-AK-CT-2001-L00-GF	Philips 8W UV Lamp Kit w/ Wire Harness and Bung	
51	10-4008	PL-1027	UV Lamp Retaining Nut	
52	10-3004	CT-2001-B	UV Lamp Fixing Rubber (Silicon)	
53	CT-2050	CT-2050	UV Cold Tank Ass'y 4L with UV Holder & T/C-2nd Design of Scr	
54	10-4029	HT-3024	Hot Tank	
54.1	10-3030	HT-3002	Hot Tank Thermistor	
55	N/A	ST-0034-L00-00	Upper base HCA	

56	N/A	ST-8287	3minutes UV Timer PCB Fixing Bracket	
57	N/A	EN-0134-L00-00	WL3 NEW HCA MAIN PCB	
58	12-1000	CO-9007	Wire Condenser WL650FS	
59	PU-4028	PU-4028	JG Bulkhead Union 1/4" x 1/4"	
60	PU-4031	PU-4031	1/4" PE Pipe	
61	PU-4008	PU-4008	JG Equal Elbow 1/4"	
62	FT-0053 FT-0035 FT-0063	FT-0053 FT-0035 FT-0063	WL Inline Filter	
63	PU-4008	PU-4008	JG Equal Elbow 1/4"	

64	PU-4031	PU-4031	1/4" PE Pipe	
65	PU-4008	PU-4008	JG Equal Elbow 1/4"	
66	PU-0017-100-00	PU-0017-100-00	MS DC Solenoid Valve SWV24-01	
67	PU-4008	PU-4008	JG Equal Elbow 1/4"	
68	PU-4031	PU-4031	1/4" PE Pipe	
69	PU-4011	PU-4011	JG Equal Tee 1/4"	
70	PU-0017-100-00	PU-0017-100-00	MS DC Solenoid Valve SWV24-01	
71	PU-4008	PU-4008	JG Equal Elbow 1/4"	

72	PU-4031	PU-4031	1/4" PE Pipe	
73	PL-1382	PL-1382	Hot Faucet	
74	PU-4031	PU-4031	1/4" PE Pipe	
75	PU-4011	PU-4011	JG Equal Tee 1/4"	
76	PU-0017-100-00	PU-0017-100-00	MS DC Solenoid Valve SWV24-01	
77	PU-4007	PU-4007	JG Reducing Elbow 5/16"x1/4"	
78	PU-4014	PU-4014	JG LLDPE Tube - Blue 8mm	
79	CT-2050	CT-2050	UV Cold Tank Ass'y 4L with UV Holder & T/C-2nd Design of Scr	

80	PU-4014	PU-4014	JG LLDPE Tube - Blue 8mm	
81	N/A	ST-0330-L00-00	WL3 Countertop HCA UT model - Cold Water Faucet	
82	PU-0017-I00-00	PU-0017-I00-00	MS DC Solenoid Valve SWV24-01	
83	PU-4007	PU-4007	JG Reducing Elbow 5/16"x1/4"	
84	PU-4014	PU-4014	JG LLDPE Tube - Blue 8mm	
85	10-4029	HT-3024	Hot Tank	
86	PL-4064-L00-00	PL-4064-L00-00	Silicone Pipe 5/16" Non-WRAS	
87	PL-4064-L00-00	PL-4064-L00-00	Silicone Pipe 5/16" Non-WRAS	

88	PU-4031	PU-4031	1/4" PE Pipe	
89	PU-4011	PU-4011	JG Equal Tee 1/4"	
90	PU-4031	PU-4031	1/4" PE Pipe	
91	PL-4064-L00-00	PL-4064-L00-00	Silicone Pipe 5/16" Non-WRAS	
92	PL-4064-L00-00	PL-4064-L00-00	Silicone Pipe 5/16" Non-WRAS	
93	PU-4031	PU-4031	1/4" PE Pipe	
94	N/A	ST-0327-L00-00	WL3 Cold Faucet Fixing Bracket for HCA UT	

WL3 IT TOWER WATER FLOW DIAGRAM

