

WL270 DRAWINGS AND PARTS LISTS

Yellow = Consumables

Green = Recommended spare parts

Wetted Drawing

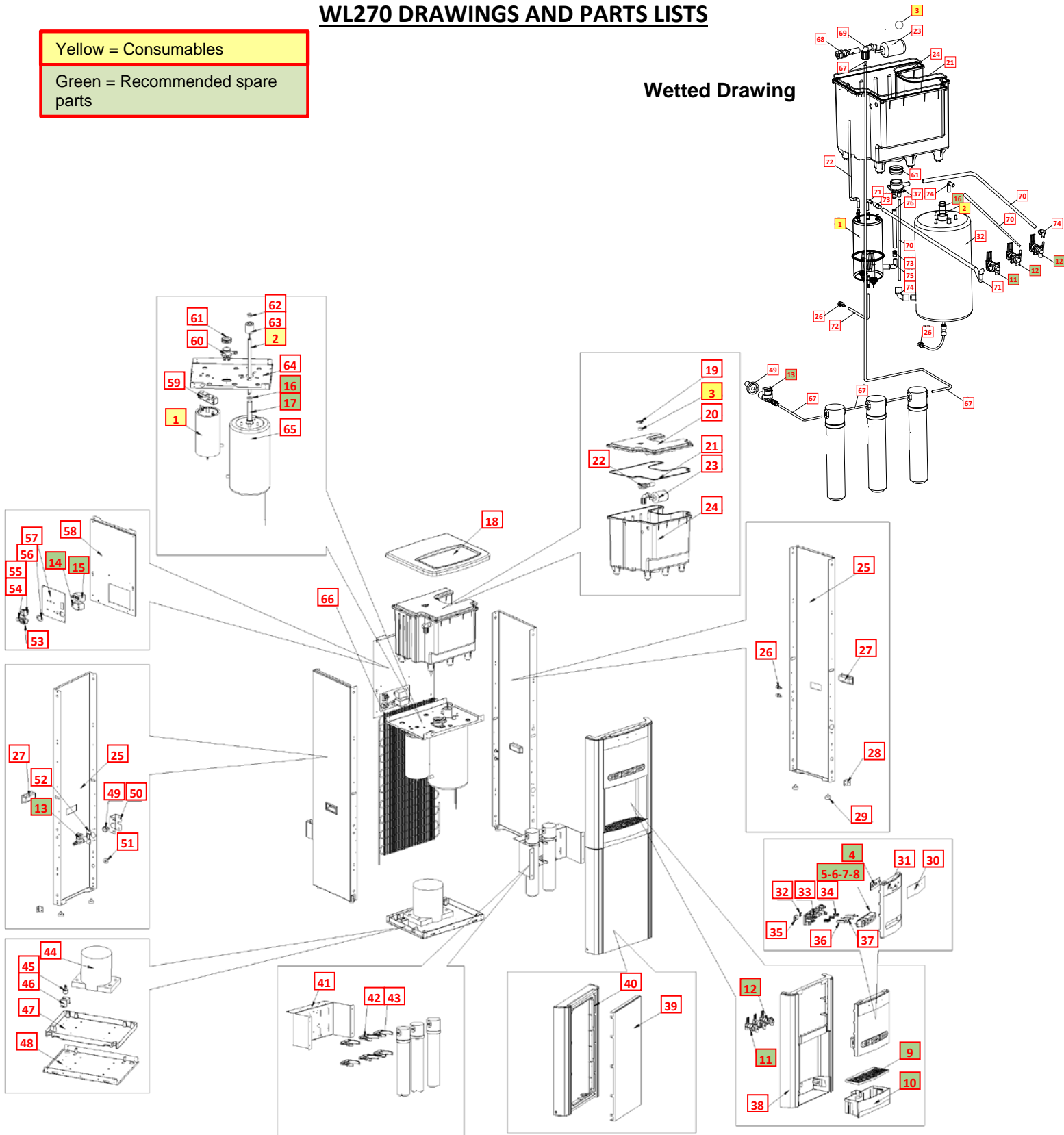

No	WLCP Part No.	Description	Part No	Stocked?	
Consumables					
1	19-1071	Hot Tank Assembly 1.6 Liter 110V 600 W	HT-0004-L00-00	Yes	
1.1	19-2065	Hot Tank Replacement Tube Kit <i>Replace when replacing the Hot Tank</i>	AK-0067-NWS	Yes	
2	10-2350	8W UV Lamp Assembly with Starter Wire Harness	CT-2001-I00-00	Yes	
3	19-1052	Carbon Air Filter	PU-4108-L00-00	Yes	
Not Shown	01-2076	Scale Kleen	NA	Yes	
Recommended Spare Parts					
1.2	19-1078	Hot Tank Thermostat - 81°C (178°F) <i>Recommend stocking 2 each for every 10 units purchased</i>	EL-0158-L00-00	Yes	
1.3	19-1079	Hot Tank Overload 97°C (206.6 °F) <i>Recommend stocking 2 each for every 10 units purchased</i>	EL-0159-L00-00	Yes	
1.4	12-6900	Cover for Hot Tank Overload and Thermostat <i>Recommend stocking 1 each for every 10 units purchased</i>	ST-8289	Yes	
4	19-1002	Display PCB <i>Recommend stocking 1 each for every 10 units purchased</i>	EN-6112	Yes	
5	19-1041	Middle Push Button – COLD <i>*purchase sticker separately</i> <i>Recommend stocking 1 each for every 10 units purchased</i>	PL-1264-L00-BK	Yes	
5.1	LP-0426- L00-00	Blue Cold Dispensing Sticker <i>Recommend stocking 2 each for every 10 units purchased</i>	LP-0426-L00-00	Yes	
6	19-1042	Right Push Button - AMBIENT <i>*purchase sticker separately</i> <i>Recommend stocking 1 each for every 10 units purchased</i>	PL-1263-L00-BL	Yes	
6.1	LP-0424- L00-00	Green Ambient Dispensing Sticker <i>Recommend stocking 2 each for every 10 units purchased</i>	LP-0424-L00-00	Yes	

7	19-1040	Left Push Button HOT <i>*purchase sticker separately</i> <i>Recommend stocking 1 each for every 10 units purchased</i>	PL-1262-L00-BK	Yes	
7.1	LP-0423-L00-00	Red Hot Dispensing Sticker <i>Recommend stocking 2 each for every 10 units purchased</i>	LP-0423-L00-00	Yes	
8	19-1043	Left SAFETY Push Button – Blank <i>*purchase sticker separately</i> <i>Recommend stocking 1 each for every 10 units purchased</i>	PL-1265-L00-00	Yes	
8.1	LP-0425-L00-00	Red Hot SAFETY Dispensing Sticker <i>Recommend stocking 2 each for every 10 units purchased</i>	LP-0425-L00-00	Yes	
9	19-2025	Drip Tray Grill Black <i>Recommend stocking 2 each for every 10 units purchased</i>	PL-1270	Yes	
	19-1048	Blue Drip Tray Grill <i>Recommend stocking 2 each for every 10 units purchased</i>	PL-1270-A	Yes	
10	19-2020	Drip Tray Black <i>Recommend stocking 2 each for every 10 units purchased</i>	PL-1289-B	Yes	
	19-1032	Blue Drip Body <i>Recommend stocking 2 each for every 10 units purchased</i>	PL-1289-F	Yes	
11	19-1050	Hot Water Faucet Assembly <i>Recommend stocking 1 each for every 10 units purchased</i>	PL-1260-D	Yes	
12	19-1051	Ambient and Cold-Water Faucet Assembly <i>Recommend stocking 1 each for every 10 units purchased</i>	PL-1260-E	Yes	
13	19-1001	Inlet Solenoid Valve 120V <i>Recommend stocking 1 each for every 10 units purchased</i>	PU-4096	Yes	
14	10-3010	UV Lamp Ballast 120V 60Hz 8W (E57946B) <i>Recommend stocking 1 each for every 10 units purchased</i>	EL-5006-A CN	Yes	
15	19-1069	Cold Tank Thermostat Low Temp - 3°C (37.4°F) <i>Recommend stocking 1 each for every 10 units purchased</i>	CT-2070-A	Yes	
15.1	LP-0326	Cold Thermostat Cover Label <i>Recommend stocking 1 each for every 10 units purchased</i>	LP-0326-L00-00	Yes	

16	10-2500	Quartz Sleeve O-ring <i>Recommend stocking 1 each for every 10 units purchased</i>	CT-2006	Yes	
17	10-1400	Quartz Sleeve for 8W Lamp <i>Recommend stocking 1 each for every 10 units purchased</i>	CT-2002	Yes	
Remaining Parts					
18	19-5005	Black Top Cover	PL-1254	Yes	
	19-1033	Blue Top Cover	PL-1254-A	Yes	
19	19-1076	Air Filter Silicone Cap	PL-1290	Yes	
20	19-1038	Reservoir Cover	PL-1259	Yes	
21	19-1056	Reservoir Cover Silicon Seal	PU-4099	Yes	
22	19-1004	Water Level Controller with Wire	PU-4100	Yes	
23	19-1072	Floater Assembly	PU-4097	Yes	
24	19-1037	Gravity Fed Plastic Reservoir Transparent 3-Gallon	PL-1258	Yes	
25	19-1019	Side Panel	ST-8212	Yes	
26	14-5011	Drain valve	CT-2031	Yes	
27	12-8058	Plastic Silver Handle	PL-1123	Yes	
28	19-1021	Side Panel Bracket	ST-8229	Yes	

29	10-3083	Unit Rubber Feet	ST-8016	Yes	
30	19-1014	Front Panel Display Sticker	LP-7180	Yes	
31	19-5010	Front Top Hatch Panel - Black	PL-1257	Yes	
	19-1036	Front Top Hatch Panel – Blue	PL-1257-A	Yes	
32	19-1029	Spring for Hot Safety Lock	CST-8327	Yes	
33	19-1047	Faucet Bracket	PL-1269	Yes	
34	19-1028	Spring for Push Pin	CST-8326	No	
35	19-1045	Hot Safety Push Button Safety Lock	PL-1267	Yes	
36	19-1044	Gravity Hot Safety Push Button pin	PL-1266	Yes	
37	19-1046	Gravity Faucet Push Pin	PL-1268	Yes	
38	19-1034	Top Front Panel for Drip Tray	PL-1255	Yes	
39	19-5015	Front Lower Insert Panel	PL-1149A	Yes	
40	19-1035	Bottom Panel - Silver	PL-1256	Yes	
41	19-1016	Filter Bracket	ST-8206CN	Yes	

42	10-3099	3" Filter Clip	PU-4024	Yes	
43	10-3098	2" Filter Clip	PU-4025	Yes	
Verify compressor in machine before ordering parts as the Compressor P/N CO-0020-L00-00 and 10-2200 (CO-0001A) and related parts are not interchangeable.					
CO-0020-L00-00 Compressor					
44A.1	CO-0020-L00-00	LG Compressor 120V R134A CSB035LJCM	CO-0020-L00-00	Yes	
44A.2	CO-0019-L00-00	Compressor Capacitor	CO-0019-L00-00	Yes	
44A.3	ST-0216-L00-00	Capacitor Bracket	ST-0216-L00-00	Yes	
44A.4	CO-0017-L00-00	PTC Relay	CO-0017-L00-00	Yes	
44A.5	CO-0018-L00-00	Overload Protector	CO-0018-L00-00	Yes	
CO-9001-A / 10-2200 Compressor					
44B.1	10-2200	Compressor (R134a 1/8HP) 120V/60Hz	CO-9001-A	Yes	
44B.2	10-3003	Compressor Starter Relay	CO-9016	Yes	
44B.3	10-5018	Compressor Overload	CO-9015	Yes	
44.1	12-1001	Filter Dryer	CO-9008	Yes	
45	19-1005	Leak Detection Floats Connection	PU-4100-C	Yes	
46	19-1025	Level Sensor Bracket for Leak Detector	ST-8232	Yes	
47	19-1049	Leak Tray	PL-1292	Yes	

48	12-1602	Bottom Shelf	ST-8035	Yes	
49	19-1008	JG Adaptor 1/4" (CI320816S) for Inlet Solenoid Valve	PU-4104	Yes	
50	19-1026	Cover of Inlet Solenoid Valve	ST-8233	Yes	
51	NA	Rubber O-ring for GF Side Panel Drain Hole	PL-1293	No	
52	19-1020	Inlet Solenoid Valve Bracket	ST-8214	Yes	
53	19-1090	Power Line Noise Filter, ElectroMagnetic Interference filter (EMI)	EL-5029	Yes	
54	10-3014	Fuse Holder & Fuse	EL-5053	Yes	
55	10-3008	Red Compressor and Heater Switch	EL-5004	Yes	
56	19-1015	Power Socket	ST-8052	Yes	
57	19-1022	GF Back panel access panel for electronics service	ST-8230A	No	
58	NA	Back Panel	ST-8210	No	
59	12-8006	Hot Tank Bracket	ST-8120	Yes	
60	19-1039	Water Inlet Port to tank	PL-1261	Yes	
61	19-1057	Silicon seal - Inlet Port to Tanks	PU-4109	Yes	

62	10-8085	UV Lamp Fixing Rubber (Silicon)	CT-2001-B	Yes	
63	12-1210	UV Lamp Retaining Threaded Nut	PL-1128	Yes	
64	19-1018	Upper Shelf	ST-8211	Yes	
65	NA	Cold Tank with Thermistor	CT-0013-L00-00	No	
66	19-1000	Wire Condenser	CO-9040	No	
67	NA	JG LLD PE Tube - Blue O.D.1/4"	PU-4031	Purchase from John Guest	
68	19-1073	Floater fitting & Nut for Gravity	PU-4098	Yes	
69	19-1009	JACO fitting OD 1/4"	PU-4116	Yes	
70	19-1099	1/2" Pipe White Tubing John Guest PN PE-16-GI-0250F-W	PU-4126-KR	Yes	
71	19-1060	Silicon Elbow Tube for Hot Outlet <i>Included in AK-0067-NWS</i>	PL-0207-L00-00	Yes	
72	10-7040	Silicone Pipe 5/16"	PL-4064-L00-00	Yes	
73	19-1003	PP Straight Connector for Silicon Pipe	PU-4101	Yes	
74	NA	1/2" Elbow fitting (PP0316W)	PU-4141-KR	Purchase from John Guest	
75	PL-0206-KR	Silicon Elbow for Hot Tank Inlet / Outlet <i>Included in AK-0067-NWS</i>	PL-0206-KR	Yes	
76	PL-4126-KR	Silicone Pipe 1/2"	PL-4126-KR	Yes	
Not Shown	10-3007	Power Cord 120V – 1825 mm	EL-5001-B	Yes	