

## FILTER FLUSHING PROCEDURE

The *Wellsys i30 Ice and Water Dispenser* is paired with a single ICE10K filter, a Fiber-Core Filter with Phosphate for Scale Reduction. This filter must be flushed prior to installation into the units water supply. To flush, follow the procedure below:

1. Insert and lock the filter cartridge into the filter head.



2. Connect the inlet of the filter head to the water supply using 3/8" LLDPE tubing. Take note of the small arrow on top of the head indicating the proper flow direction. Using the same tubing, connect a length of tube to the outlet of the filter head, such that it can be routed to a drain or sink.



3. Turn on the water and check for leaks at both ports of the filter head, and between the filter and filter head union. If leaks occur, and cannot be diagnosed, call Product Support.



4. Allow 5 gallons of water to run through the filter. Once complete, shut the water off, and continue to the **Filter Installation** section.

## **i30 PM GUIDE**

To ensure proper function and effectiveness of the **Wellsys i30** unit, preventative maintenance must be performed on a timely basis, at a bare minimum of once per year, but recommend at least every 6 months. PMs typically consist of filter changes but do also require hopper, auger, and reservoir descaling on a yearly basis, especially if not using RO filtration. The filter change schedule is listed below. [DO NOT run the filtration system in the unit before flushing the filters.](#)

It is imperative to regularly change the filters on the Wellsys i30 unit every 6 months. Changing the filters keeps the tanks clean and the water and ice tasting fresh. Failing to change filters regularly can also cause premature degradation of the auger assembly, which can increase maintenance costs. [Refer to the filter flushing guide for the proper flushing procedure.](#)

Regularly descaling the unit will also help to improve the water quality and prevent costly maintenance (or even replacement) of the auger assembly. The descaling procedures are outlined below.

### **DESCALING PROCEDURE**

The following procedure outlines how to properly descale the auger assembly, hopper, and reservoir.

#### **What you will need:**



Nitrile  
Gloves



Safety Glasses



SafeClean Plus



1-Gallon  
Pitcher



Step  
Stool/Ladder



WypAll Lint Free  
Towels



Microfiber  
Towels



32oz Spray  
Bottle

- Safety Glasses
- SafeClean Plus (Recommended)
- 1-gal Pitcher
- Nitrile Gloves
- WypAll Towels for descale processes
- Microfiber towels – Exterior
- 1 32oz spray bottle
- Step Stool or Ladder

1. Begin by preparing a “Descaling Solution” by mixing a half bottle (4oz) of SafeClean Plus ice machine descaling solution with 60oz of hot water, making a total solution of 1/2-gallon.
2. Remove the sprayer from the spray bottle and transfer descale solution from the pitcher to the bottle. Leave the sprayer off and set the solution aside. The bottle will be used to fill the water reservoir during the descale process. The process will use up to 2 liters so the bottle will need to be filled twice. **Pro Tip:** To produce a suds free descaling solution, fill the 1-gallon container with water first, then pour the descaler into the water and stir.



3. Open the Front Door Panel of the unit. To do this, simply use a flathead screwdriver to turn the slotted key counter-clockwise to unlock the panel. Then, give a firm pull on the bottom lip of the door panel.



4. Remove the Top Panel. After opening the Front Door Panel, locate the two screws circled in RED and set them aside. Pull the panel about 1” forward, lift, and remove.

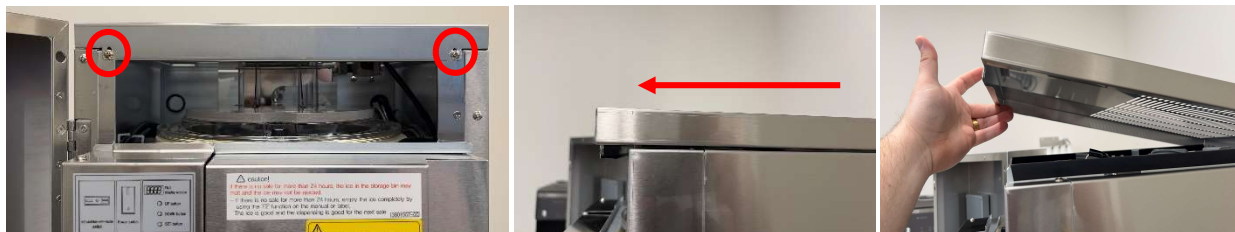

- With the water supply “ON”, set the “Ice-Off-Wash” (IOW) switch to “Off” and then turn the Main Power switch “ON”.

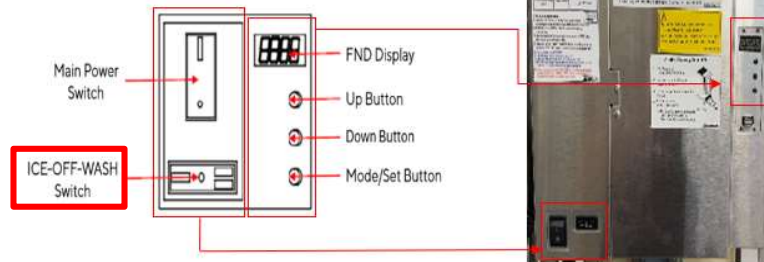

- Perform a “Forced Drain Function” to drain the reservoir of any remaining water. To perform the **Forced Drain Function**: With the Main Power Switch set to “ON,” press the “DOWN” + “MODE/SET” buttons simultaneously for 3 seconds on the FND (Flexible Numeric Display) panel. Water will purge from the water reservoir and auger housing for 90 seconds.

- Remove the top cover to the unit then remove the hopper cover by removing the three white colored thumb screws around the perimeter of the cover, circled in **RED**. The lid has a switch connected to a cable. There is no need to disconnect this, as there is enough slack in the cable to set the lid aside without disconnecting.



- Facing the unit, remove the ice dispense auger components from the ice hopper and set them aside. There is the main auger, and a smaller piece that slides into a guide plate inside the hopper. Remove this smaller piece as well.



- Using the prepared solution in the spray bottle, pour 1.5 liters into the Sanitizing/Descal Funnels on the top of the reservoir and allow to sit for 10 min. The bottle will have to be refilled, as it holds approx. 1 liter. Using a larger mouth funnel (pictured) in the smaller Sanitizing/Descal Funnels will make it easier to fill the reservoir.



- Remove the three thumb screws (circled in RED) that hold the Auger Housing in place and remove the housing. Spray the auger housing with the descaling solution and wipe it dry. Spray the top portion of the auger and wipe it dry with a clean paper towel or clean microfiber towel, then reinstall auger cover.

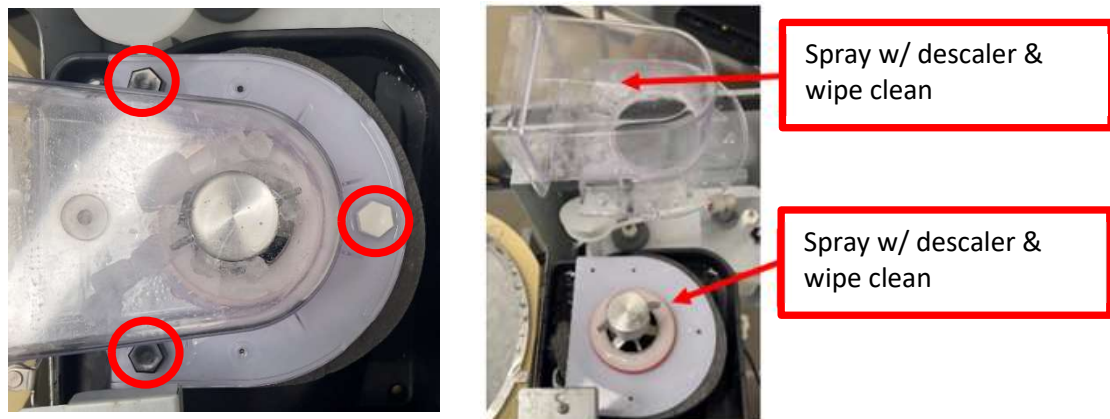

- Spray the inside of the hopper and auger components with descaling solution and let sit for 10-15 minutes, this will be rinsed later. Reinstall the auger components into the hopper. NOTE: The auger can only be installed one way, by sliding into the half-moon slot at the bottom of the hopper. Reinstall the hopper cover.

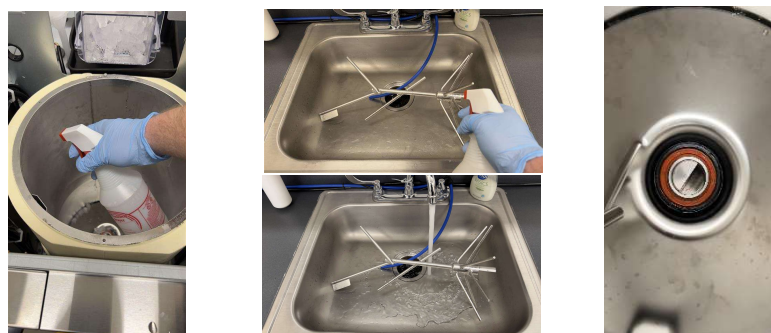

12. 10min after adding the descaler to the Sanitizing/Descal Funnel, turn the IOW switch to “Wash”.

13. The auger will rotate for 5 minutes, churning the solution inside the auger housing, then the water reservoir and auger will drain for one minute.

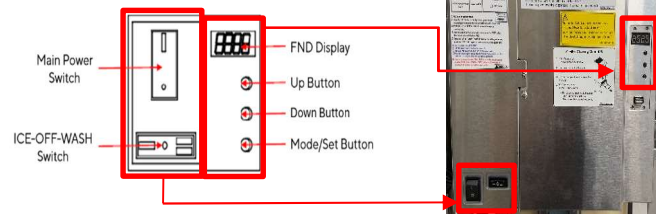

14. Next, the unit will perform 3 rinse cycles. The reservoir will fill with water, and then the auger will churn for 1 min then drain for 30 seconds, and this will repeat 2 more times. After the rinse cycle, set the IOW switch to “OFF”. After the rinse cycle, set the IOW switch to “OFF.”

15. Turn off the water supply and add a 3’ piece of tubing the “OUT” port of the filter. This tubing can be used to gently rinse the descaling solution from the ice hopper.

16. Perform a “Forced Drain Function” to drain the reservoir of any remaining water. To perform the **Forced Drain Function**: With the Main Power Switch set to “ON,” press the “DOWN” + “MODE/SET” buttons simultaneously for 3 seconds on the FND (Flexible Numeric Display) panel. Water will purge from the water reservoir and auger housing for 90 seconds.

17. Reinstall the Hopper Cover and reinstall the Top Cover.

18. Turn the water supply on and set the IOW switch to “Ice”.

19. The unit will fill with water and begin making ice, and the Descaling Procedure is complete.

### **CLEANING THE AIR FILTER**

The air filter on the 980-30 should be cleaned every PM. Remove the drip tray by pulling straight out from the unit and set aside. Locate the air filter underneath the unit and remove it by pulling the filter tab, as shown. Rinse the filter clean under a sink until it is free of debris. Once clean, simply dry the air filter with a lint free towel and reinstall it.

